

## Connections for the HDMI-ST

The High Definition Multimedia Interface [HDMI] supplies both high-definition video and multi channel digital audio. It is an ALL DIGITAL interface with NO Analogue signals. HDMI is backward compatible with the DVI interface, but without the more advanced upgrades and no audio.

### *Using the adapter*

When terminating cables onto the connector they should ALL be cut to the same length, DON'T shorten some for neatness.

The cable consists of a number of individual screen pairs normally contained with different coloured foil. The foil should be trimmed back, the drain wire should be sleeved in green (insulation stripped from 7/0.2 equipment wire is ideal) and then the end of the foil sleeved to stop the foil unravelling further. Keep these pairs twisted to the same extent as they are in the cable, don't be tempted to twist tighter. Try and maintain the twist as near as possible to the screw terminals.

Most cable manufacturers tend to use similar colours for the mains data but do vary on the other cores. Over the page the table gives typical pin outs but you should verify these for the cable you are using.

### *Panel Cutout*

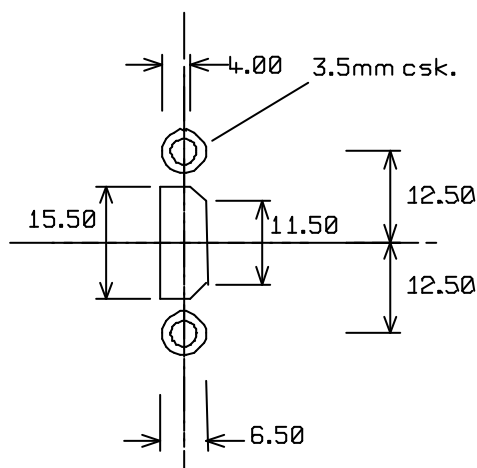

It is the same panel cutout for all Ikon HDMI adapters.

When using the HDMI-90BB the cable is to the left as viewed

| HDMI Version 1.0 to 1.3C |                    |        |             |            |                |              |              |
|--------------------------|--------------------|--------|-------------|------------|----------------|--------------|--------------|
| HDMI Pin No.             | HDMI Signal        | TDI    |             | Pro-Signal |                | IKON HDMI-26 |              |
| 1                        | TMDS Data 2+       | Blue   | Silver Foil | Blue       | Silver Foil    | Red          | Gold Foil #1 |
| 2                        | TMDS Data 2 Shield | Drain  |             | Drain      |                | Drain        |              |
| 3                        | TMDS Data 2-       | White  |             | White      |                | White        |              |
| 4                        | TMDS Data 1+       | Blue   | Blue Foil   | Blue       | Blue Foil      | Blue         | Gold Foil #2 |
| 5                        | TMDS Data 1 Shield | Drain  |             | Drain      |                | Drain        |              |
| 6                        | TMDS Data 1-       | White  |             | White      |                | White        |              |
| 7                        | TMDS Data 0+       | Blue   | Green Foil  | Blue       | Green Foil     | Green        | Gold Foil #3 |
| 8                        | TMDS Data 0 Shield | Drain  |             | Drain      |                | Drain        |              |
| 9                        | TMDS Data 0-       | White  |             | White      |                | White        |              |
| 10                       | TMDS Clock+        | Blue   | Yellow Foil | Blue       | Yellow Foil    | Brown        | Gold Foil #4 |
| 11                       | TMDS Clock Shield  | Drain  |             | Drain      |                | Drain        |              |
| 12                       | TMDS Clock-        | White  |             | White      |                | White        |              |
| 13                       | CEC                | Green  |             | Green      |                | Grey         |              |
| 14                       | Not Used           | -      |             | -          |                | Violet       |              |
| 15                       | DDC Clock          | Gold   |             | Orange     | or Pale Orange | Orange       |              |
| 16                       | DDC Data           | Violet |             | Violet     |                | Yellow       |              |
| 17                       | Ground             | Pink   |             | White      |                | Pink         |              |
| 18                       | +5V Power          | Red    |             | Red        | or Orange      | Red          |              |
| 19                       | Hot Plug Detect    | Yellow |             | Yellow     |                | White        |              |
| 20                       | SHELL              | Screen |             | Screen     |                | Screen       |              |

| HDMI Version 1.4+ with Ethernet |                                      |  |              |              |               |
|---------------------------------|--------------------------------------|--|--------------|--------------|---------------|
| HDMI Pin No.                    | HDMI Signal                          |  | IKON HDMI-26 |              | Computer Gear |
| 1                               | TMDS Data 2+                         |  | Red          | Gold Foil #1 | Brown         |
| 2                               | TMDS Data 2 Shield                   |  | Drain        |              | Drain         |
| 3                               | TMDS Data 2-                         |  | White        |              | White         |
| 4                               | TMDS Data 1+                         |  | Blue         | Gold Foil #2 | Blue          |
| 5                               | TMDS Data 1 Shield                   |  | Drain        |              | Drain         |
| 6                               | TMDS Data 1-                         |  | White        |              | White         |
| 7                               | TMDS Data 0+                         |  | Green        | Gold Foil #3 | Green         |
| 8                               | TMDS Data 0 Shield                   |  | Drain        |              | Drain         |
| 9                               | TMDS Data 0-                         |  | White        |              | White         |
| 10                              | TMDS Clock+                          |  | Brown        | Gold Foil #4 | Red           |
| 11                              | TMDS Clock Shield                    |  | Drain        |              | Drain         |
| 12                              | TMDS Clock-                          |  | White        |              | White         |
| 13                              | CEC                                  |  | Grey         |              | Green         |
| 14                              | HEC-Ethernet Data-                   |  | Violet       |              | Orange        |
| 15                              | DDC Clock                            |  | Orange       |              | White         |
| 16                              | DDC Data                             |  | Yellow       |              | Grey          |
| 17                              | DDC/CEC/HEC-Ethernet Ground          |  | Pink         |              | Drain         |
| 18                              | +5V Power                            |  | Red          |              | Red           |
| 19                              | Hot Plug Detect / HEC-Ethernet Data+ |  | White        |              | White         |
| 20                              | SHELL                                |  | Screen       |              | Screen        |

**Please note:**

Different manufactures of HDMI cables use different colours in their cables from those mentioned above. The info above is for reference only.

You may have to contact the manufacturer of your cable to find out the relevant wire colours.